

Palác Anděl

Prague 5, Plzeňská 5



Palác Anděl is a very modern administrative building in the center of Anděl, the most attractive location in Smíchov, where many leading Czech and international companies are based and there is an abundance of restaurants, shops, and other services in the immediate vicinity. This location is an ideal place for relaxation, shopping, entertainment and sports activities, as there are both relaxing corners and urban greenery nearby, as well as entertainment centers, including multiplex cinemas, as well as the Nový Smíchov Shopping Center with a wide selection of shops, services and restaurants. The total area of the building is 14,630 sqm on 6 above-ground and 2 underground floors with a sufficient amount of parking spaces and storage areas.

Palác Anděl offers a comfortable working environment and a strategic location just a few minutes from the historic center of Prague. This building is located right next to the B – Anděl metro station and provides quick connections to the airport, the D5 highway and via the Prague ring road to the D1 highway.

Currently available office space:

1st floor, offices 374 sqm

4th floor, offices 375 sqm

4th floor, offices 470 sqm

5th floor, offices 380 sqm (available from 03/2025)

5th floor, offices 1 135 sqm (available from 03/2025)

Rental price:

Offices 16.50 – 17 EUR/sqm/month

Services 164 CZK/sqm/month + tenant's electricity consumption

Parking 130 EUR/space/month

Kontakty pro zájemce o pronájem prostor:



Magda Bittmanová
+420 739 396 199
magda@pragueoffices.com

Palác Anděl

Prague 5, Plzeňská 5

Fotopříloha:



palác anděl

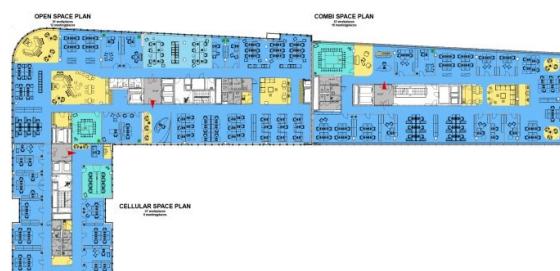

SCALE 1:500
DESIGNED BY JAROMÍR VÍTA
ARCHITECTURE BY JAROMÍR VÍTA